

**PREPARED BY:**  
 THE ZENGINEER  
 BUCKY SPARKLE, P.E.  
 378 MAIN STREET, #2  
 EASTHAMPTON, MA 01027  
 www.theZengineer.com  
 zengineerbucky@gmail.com  
 (617) 271-4004

**PROJECT:**  
 N.P.D.E.S. (EPA & DEP),  
 ARMY CORPS OF  
 ENGINEERS, &  
 CONSERVATION  
 COMMISSION PERMITTING

**PREPARED FOR:**  
 STATE PROJECT  
 GARDNER, MASSACHUSETTS

PROJECT No.: N/A  
 FILE NAME: GC 2012.02.DWG

No.	Revision	Date

STORMWATER &  
 WETLAND DESIGN

SHEET 1 OF 1

# GARDNER DISTRICT COURTHOUSE

Stormwater discharge from the parking lot had to be treated, detained and soaked back into the earth.

An Energy Dissipater protected adjacent wetlands and Water Quality Swales buffered runoff to the Infiltration Basin.

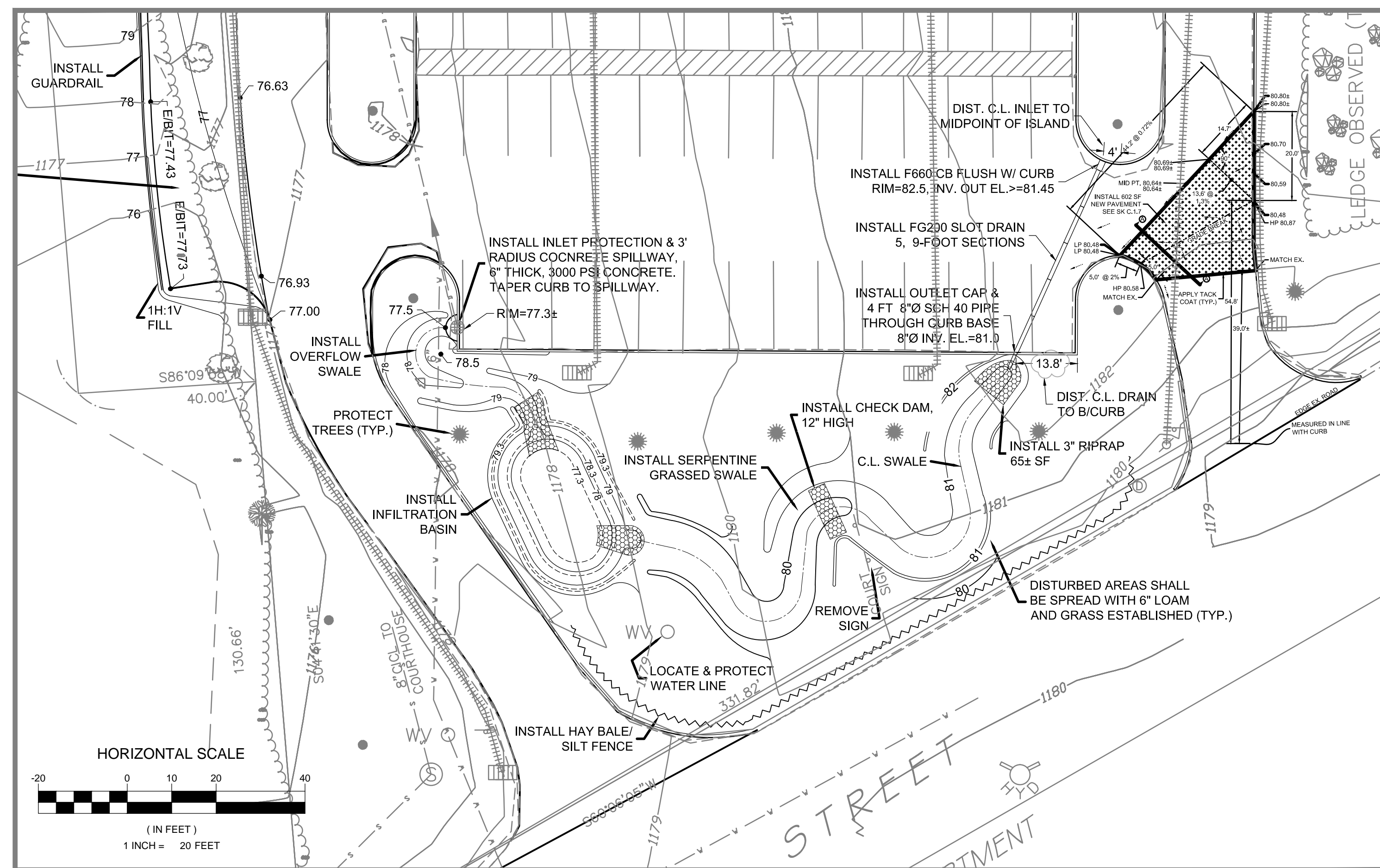

This system replaced a 40-year old pipe that poured untreated stormwater and sediment into the sensitive aquifer.

The EPA, DEP, Army Corps of Engineers & local Conservation Commission were involved in the permitting.

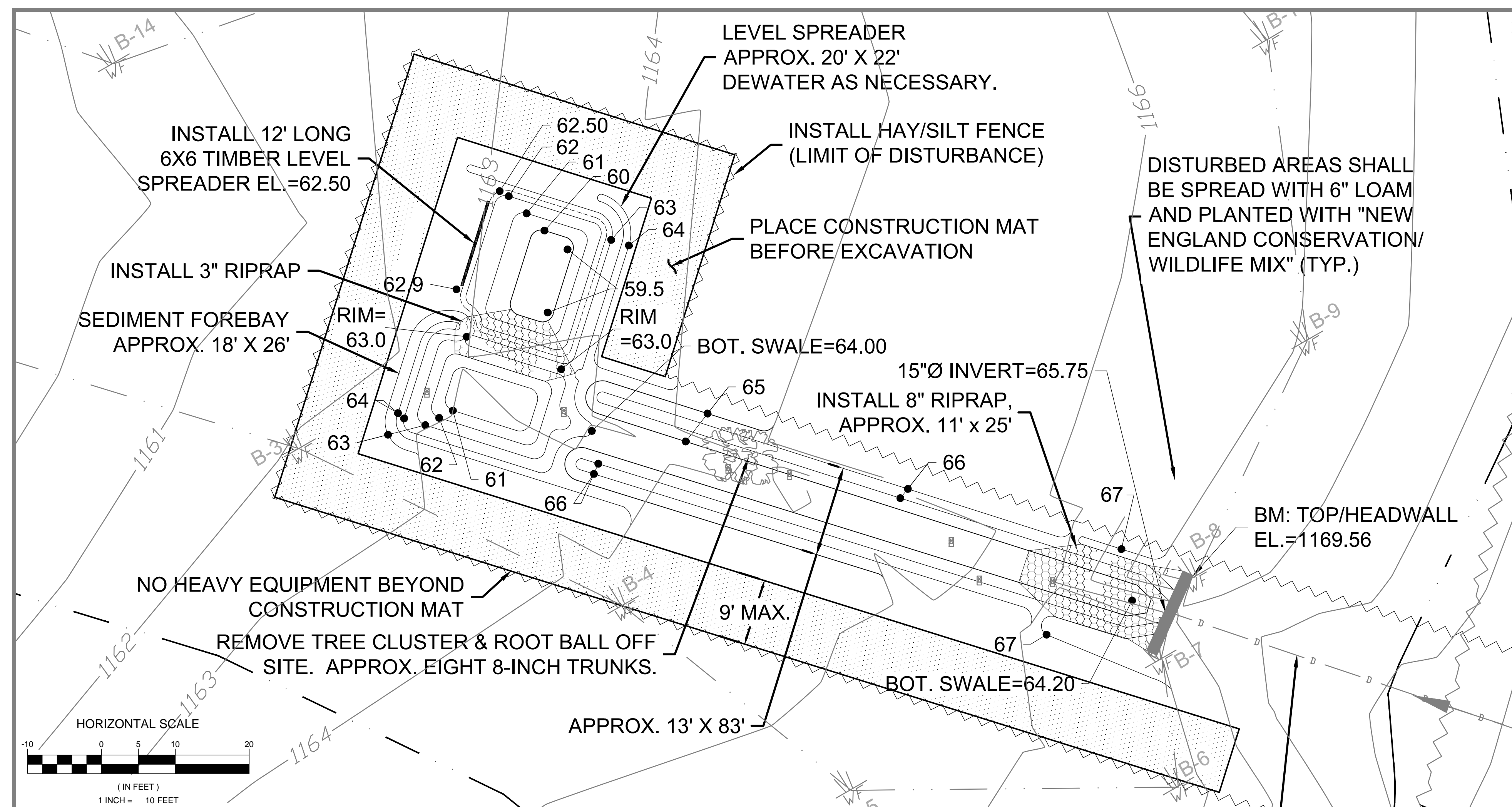

SHEET 1 OF 1